



Cranmore Place,

£325,000

FOR SALE





- **\*\*SSTC\*\***
- Three Bedrooms
- Spacious Living Areas
- Semi-Detached House
- Double Parking
- Downstairs W/C

## THE PROPERTY

**\*\*SSTC\*\***

With its combination of space, comfort, and a great location, this semi-detached house in Bath is a wonderful opportunity for anyone looking to make a new home. Don't miss the chance to view this charming property and envision the lifestyle it can offer.

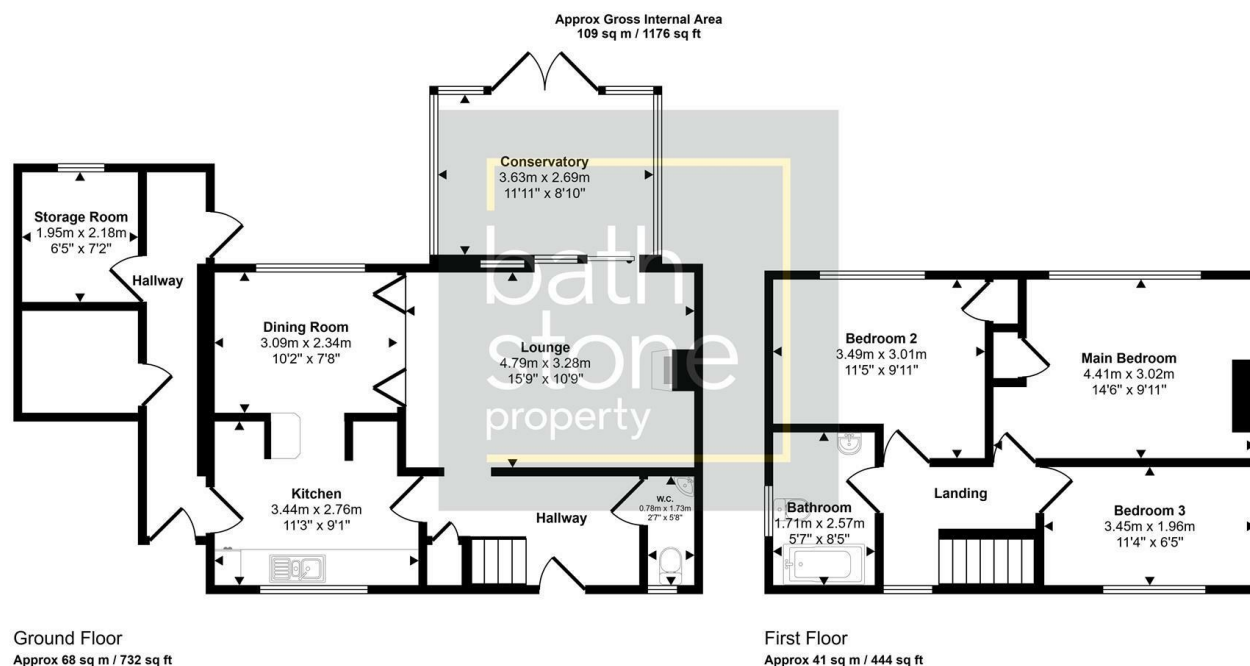

This floorplan is only for illustrative purposes and is not to scale. Measurements of rooms, doors, windows, and any items are approximate and no responsibility is taken for any error, omission or mis-statement. Icons of items such as bathroom suites are representations only and may not look like the real items. Made with Made Snappy 360.



Energy Efficiency Rating		Current	Potential
Very energy efficient - lower running costs			
(92 plus) <b>A</b>			
(81-91) <b>B</b>		84	88
(69-80) <b>C</b>			
(55-68) <b>D</b>			
(39-54) <b>E</b>			
(21-38) <b>F</b>			
(1-20) <b>G</b>			
Not energy efficient - higher running costs			
England & Wales		EU Directive 2002/91/EC	